

Believe the Numbers

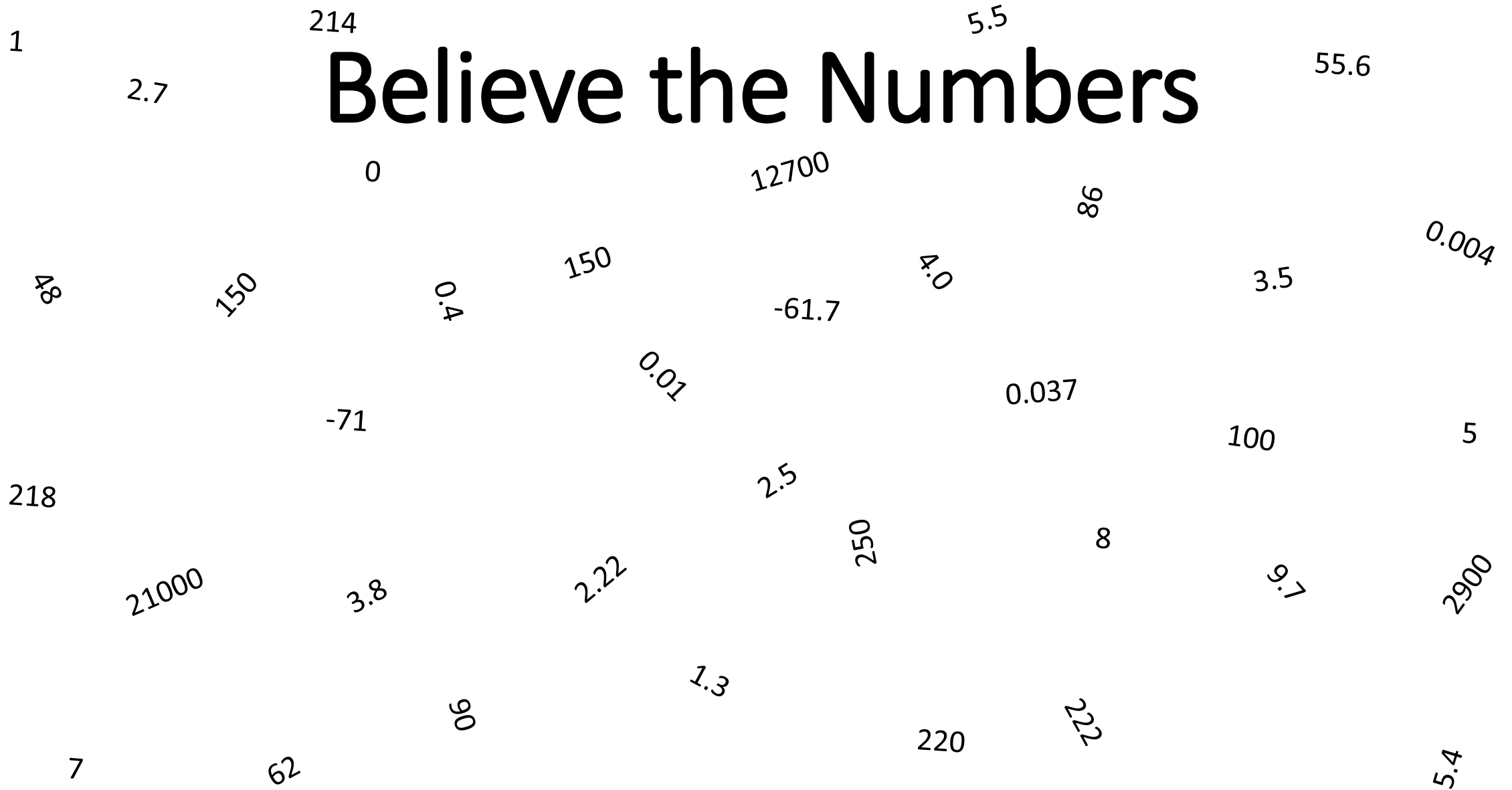

Believe the Numbers

menti.com

Code

123456

1 214 5.5 55.6 2.7

Believe the Numbers

0 12700 86 3.5 0.004 150 48 71 61.7 100 5 218 21000 3.3 2.22 1.3 220 122 5.4 7 62

menti.com question

What are the Most Common Reasons “The National Radon Hotline” gets Called???

Believe the Numbers

What is the Most Common Cause of
Ineffective Radon Mitigation
Systems???

Believe the Numbers

PFE Under Every Foundation Zone?

Believe the Numbers

If PFE is Significantly more than Target
Pressure and Rn Concentrations are
High???

Believe The Numbers and MOVE ON!

5.5



FR150
-1.4"
40 CFM

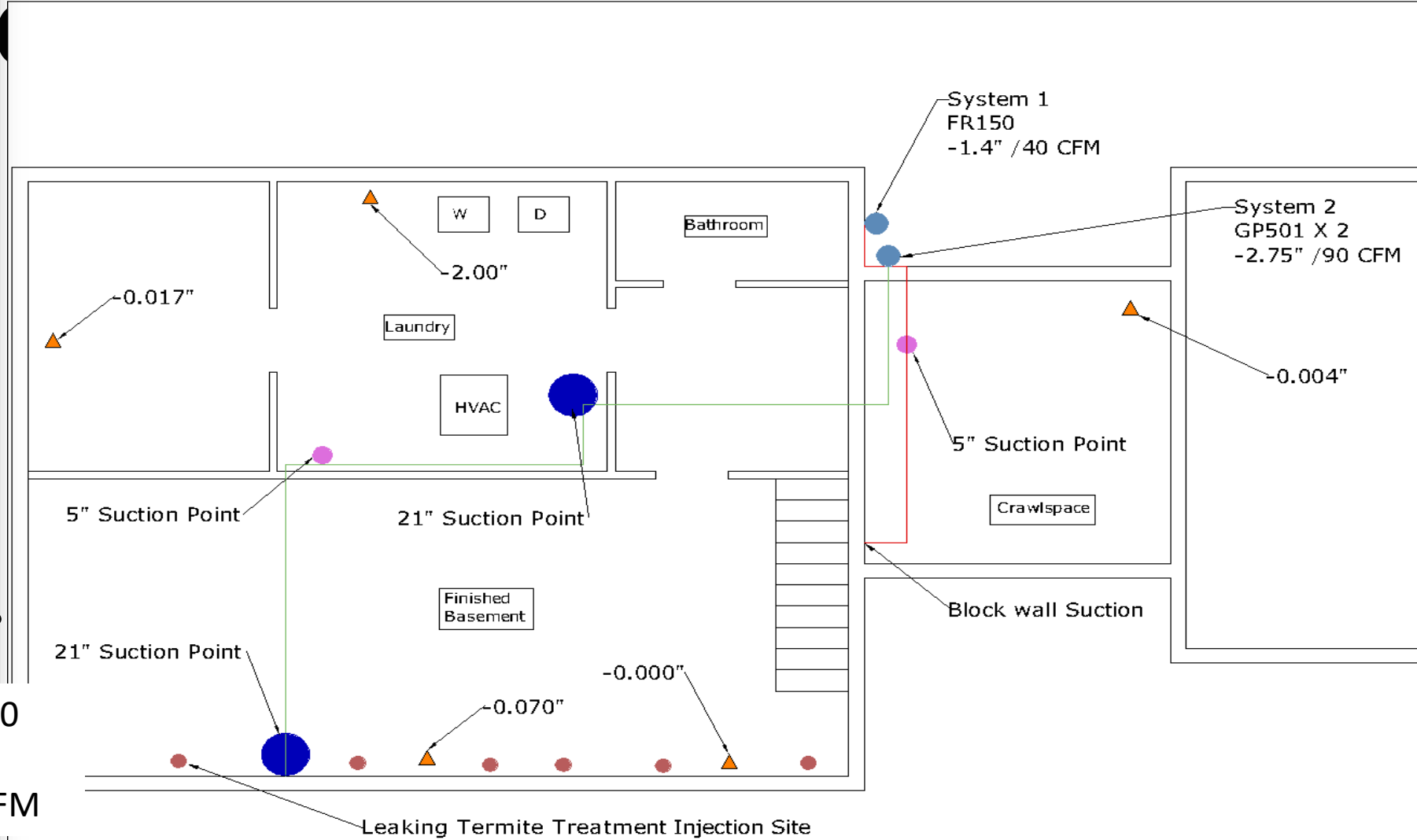

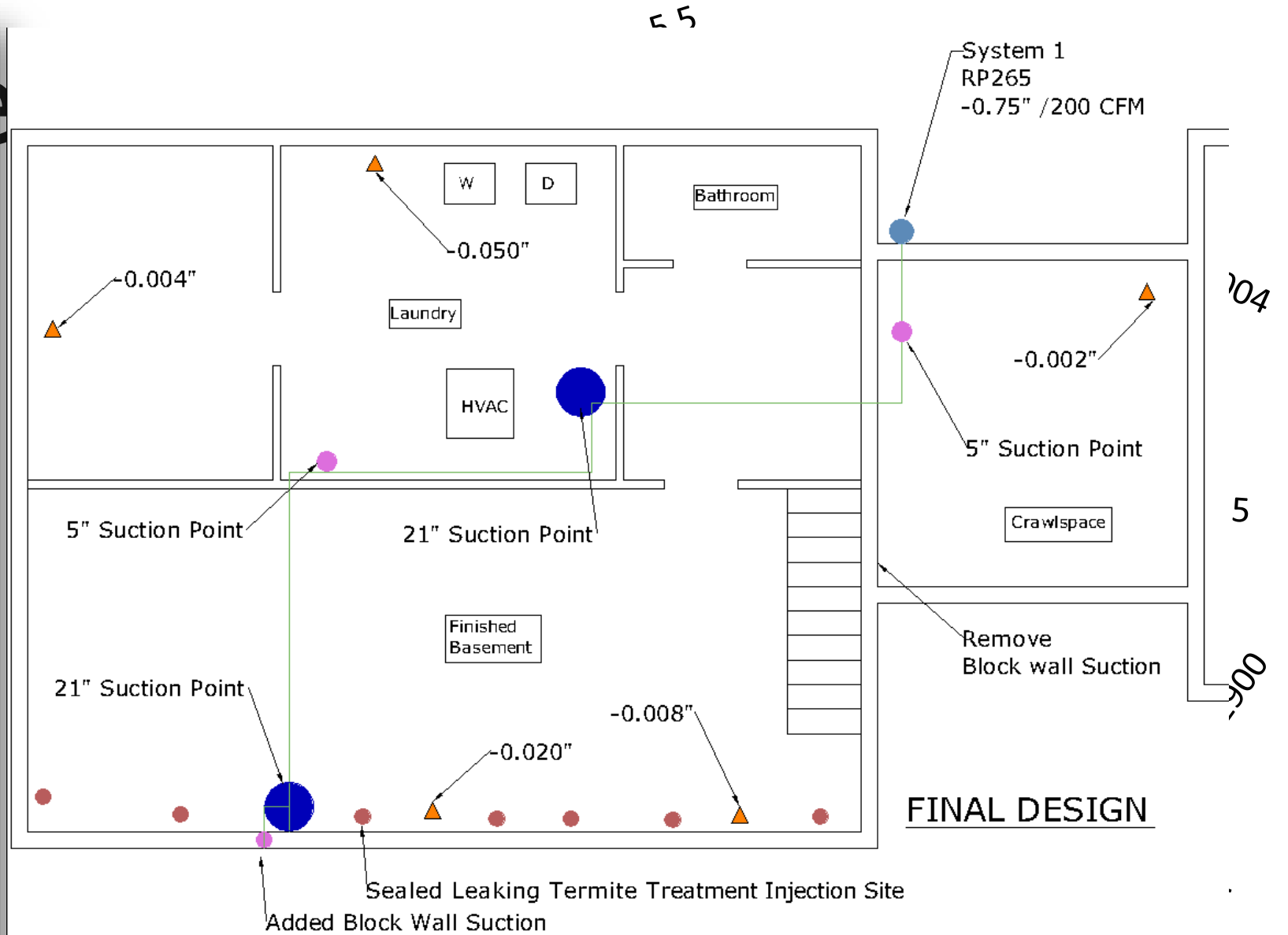

Believe the Numbers

What if PFE is close to your
minimum Target Pressure
and Rn is Elevated?

Believe the Numbers

Verify over time.

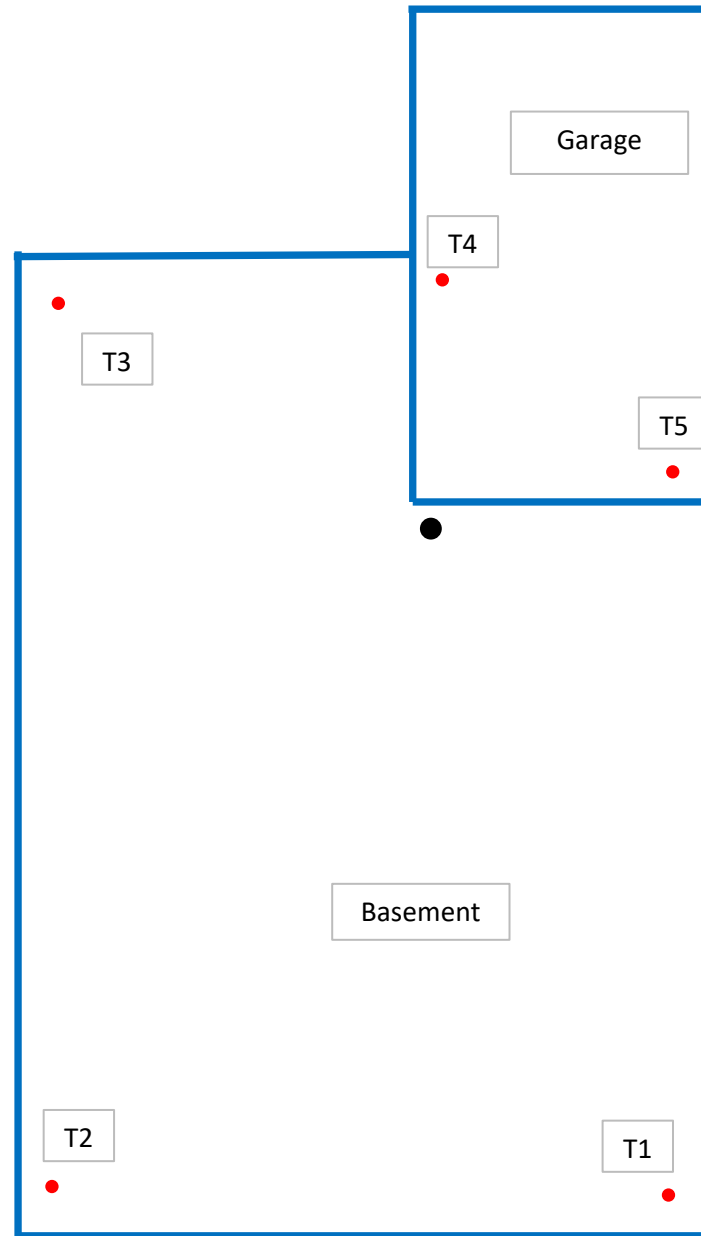

T2 = -5Pa

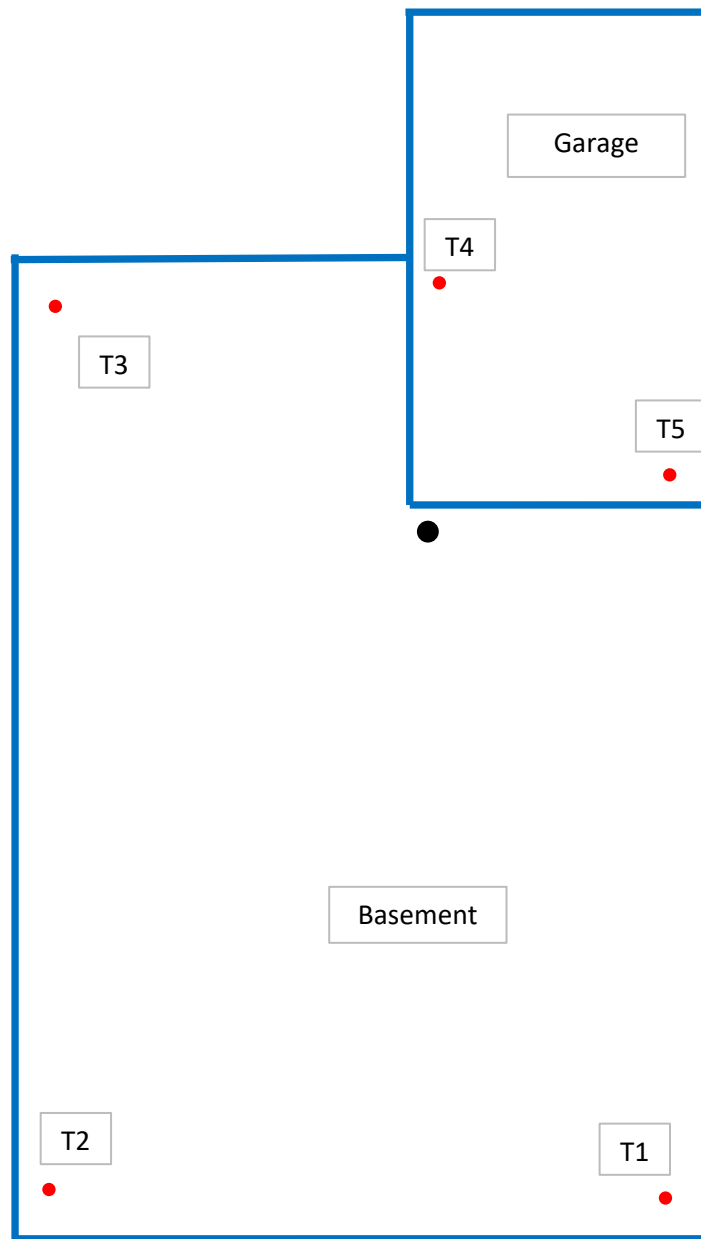

T2 = -5Pa
When I
Was There

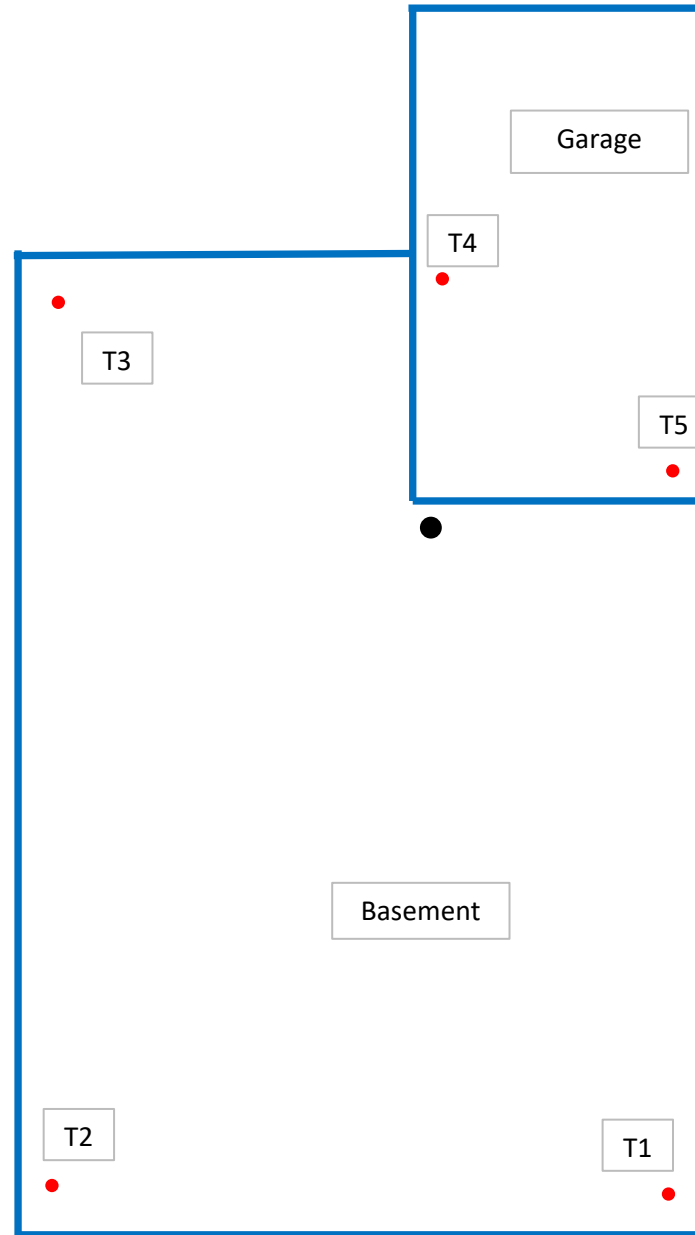

Green Line -
Pressure
Differential at
T2

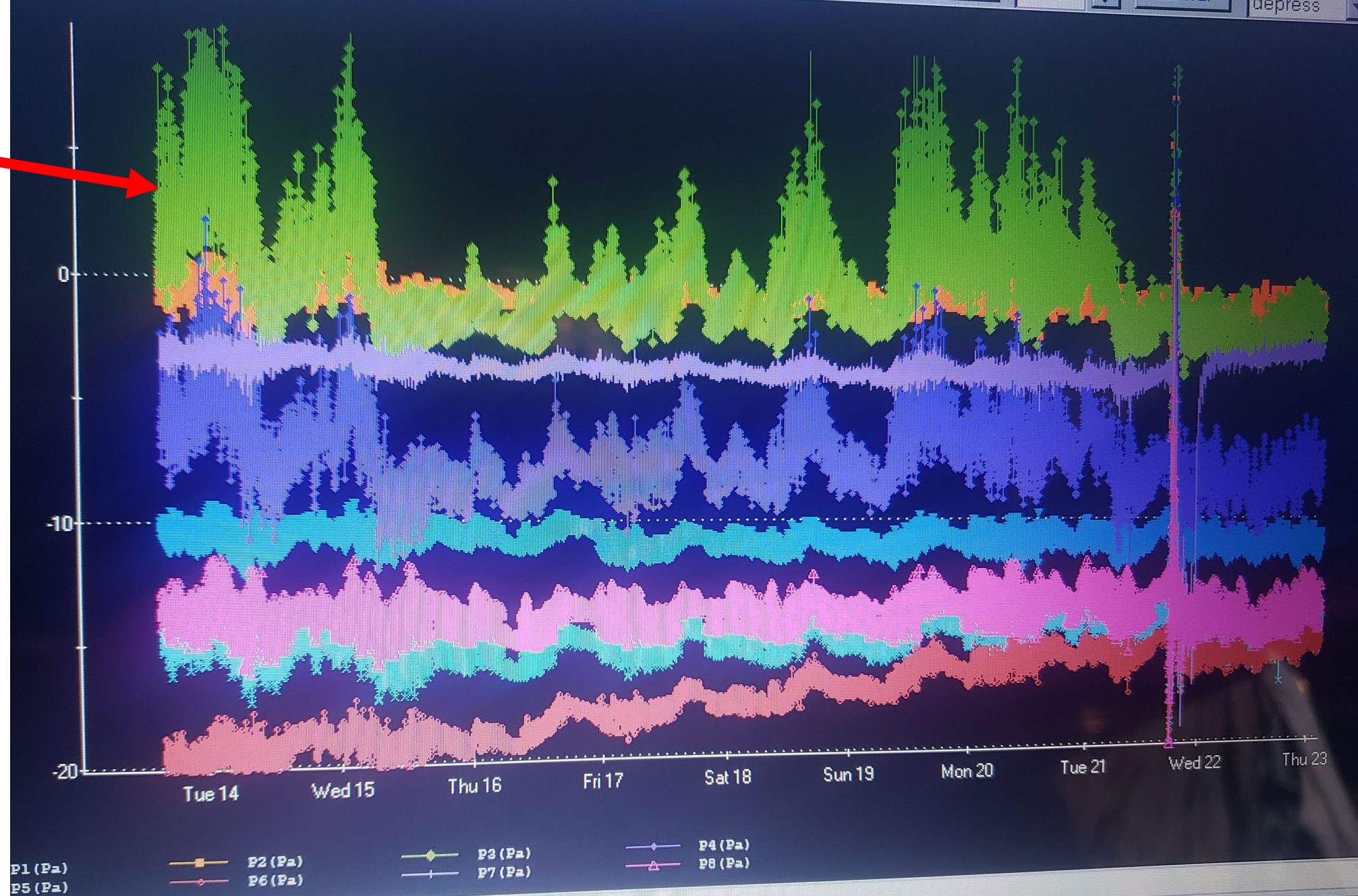

1 214 5.5 55.6
2.7
Believe the Numbers

0 12700 36 0.004
Once Verified, BELIEVE IT and
MOVE ON!

218 2.5 8 2900
2100 3.9 220 5.4
Radon Entry is Coming From
Somewhere Else!

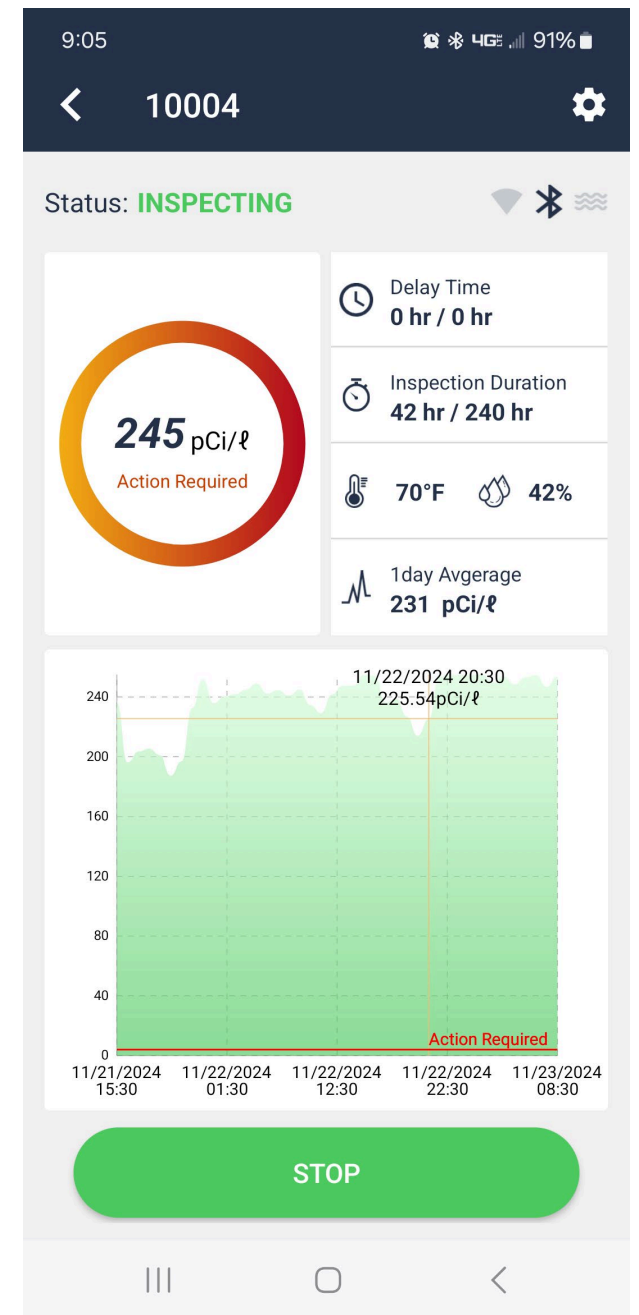

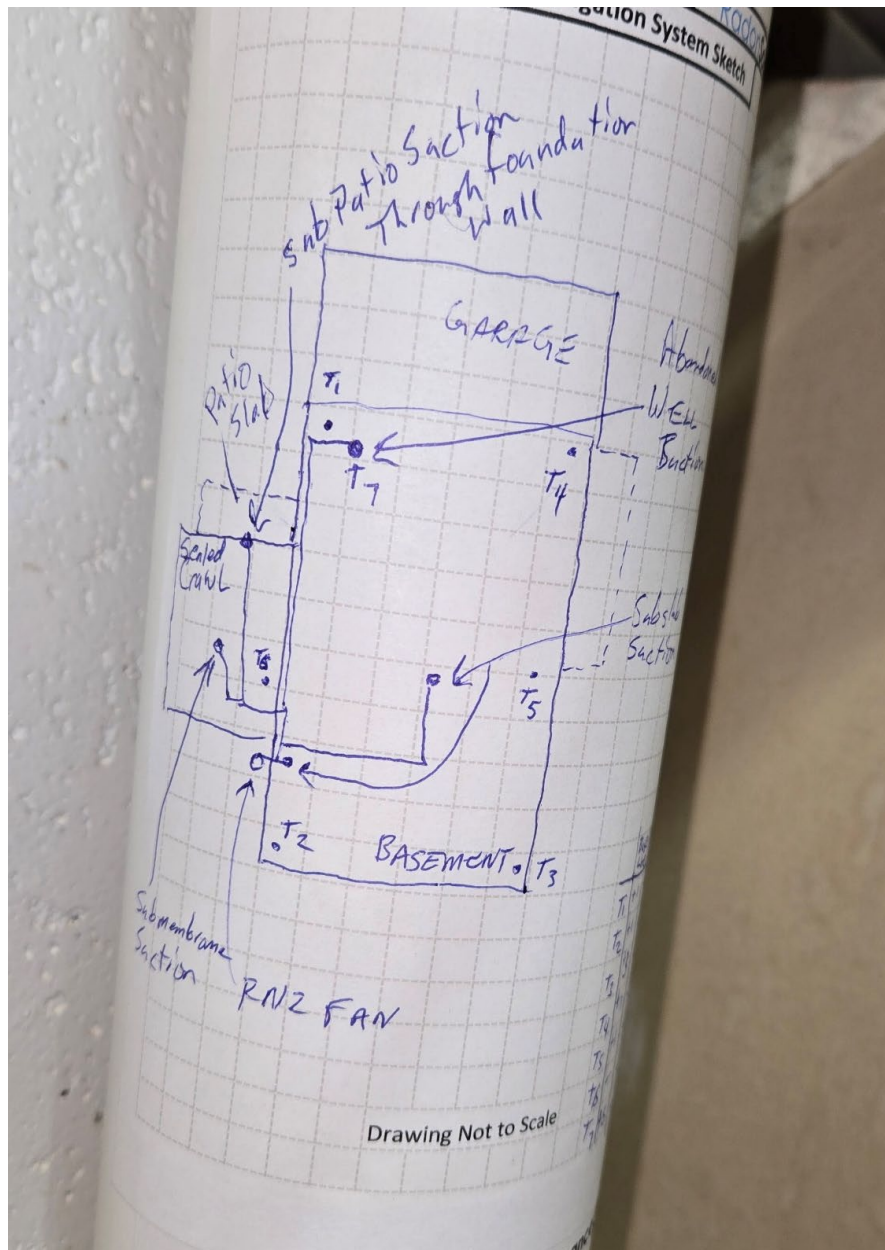

BASEMENT T₃

RN2 FAN

Drawing Not to Scale

	Base Line	Fan On
T ₁	+1	-12
T ₂	+1	-22
T ₃	+3	-11
T ₄	+1	-2
T ₅	+1	-20
T ₆	-	-5
T ₇	+5	-20

1 214 5.5 55.6
2.7
0 12700
Once Verified, BELIEVE IT and
MOVE ON!
-71 100 5
218 2.5 8
Radon Entry is Coming From
Somewhere Else!
7 62 5.4

Believe the Numbers

Look for Radon Entry

Believe the Numbers

And Keep looking.....

Believe the Numbers

And More looking.....

Believe the Numbers

- With the Sniffer
- 13 Radon Monitors at Once
- 4 Monitors Over time
- An Infrared Camera and Blower Door
- A Radiation Camera
- A Giger Counter
- With Merritt Gannett, Jesse Green, Justin Daniels, Wes Hodgden, Bruce Snead, Bill Brodhead, Bryan Coy, Kaber Robinson, and Josh Kerber by phone
- With Sam Nunemaker, Kaber Robinson, Josh Kerber, and the KDHE Radiation Department in person

Believe the Numbers

Called Original Owners

- They built the house in 1963
- They are 90ish years old and Awesome!









Believe the Numbers

So....Do I need PFE Everywhere???

Start: 10 pCi/L

Retest with first
system off: 1.0pCi/L

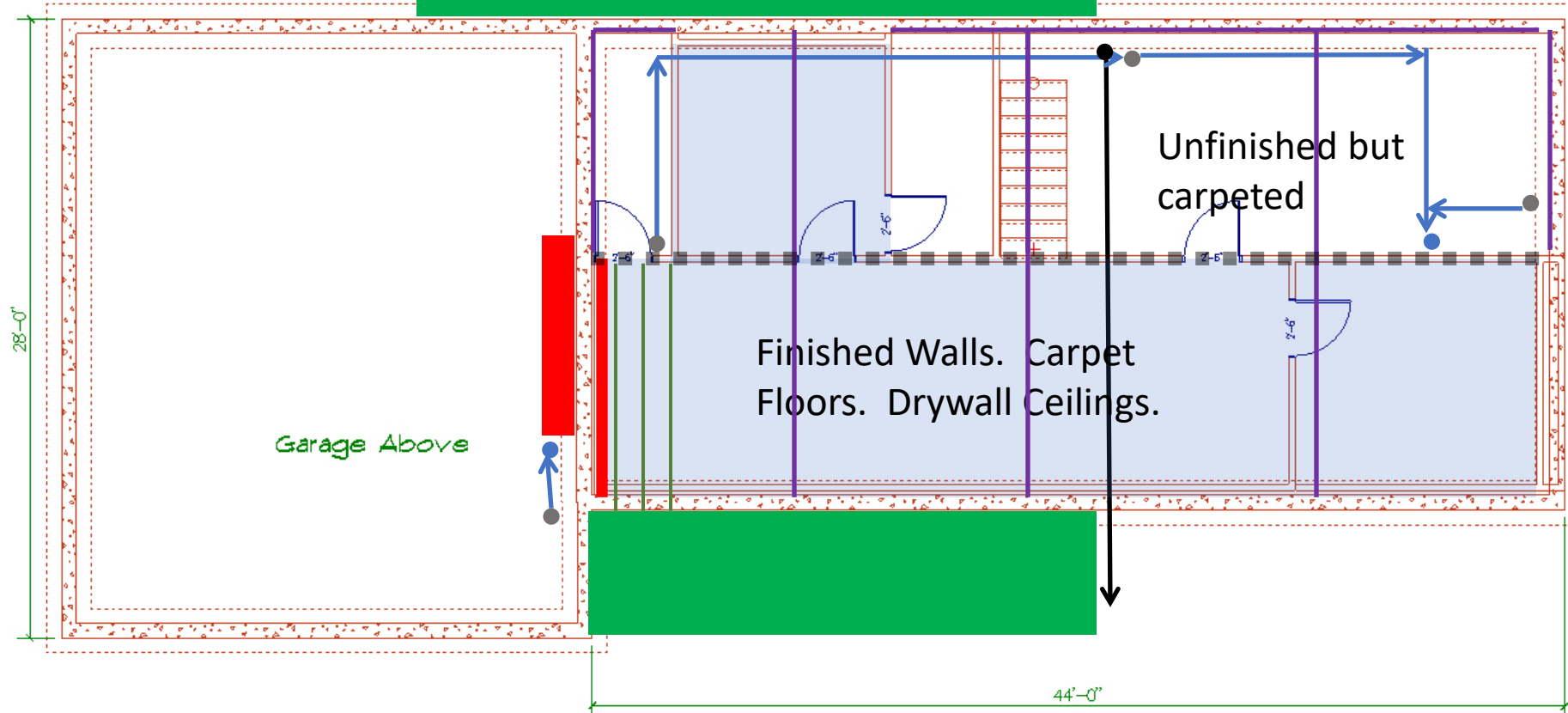

- Subslab sewer line
- Major Cracks in Slab
- Suction Points
- Radon Exhaust pipes
- Chimney and Rock Wall in Basement
- Concrete Patios

Questions???

Chad Robinson

 **BuildingPerformanceCo.**
RadonSolutions